

Hose package	L1	L2	L3	L4
P2457-1	750	2900	1450	260
P2457-2	750	2400	1450	260
P2457-3	750	2500	1500	150

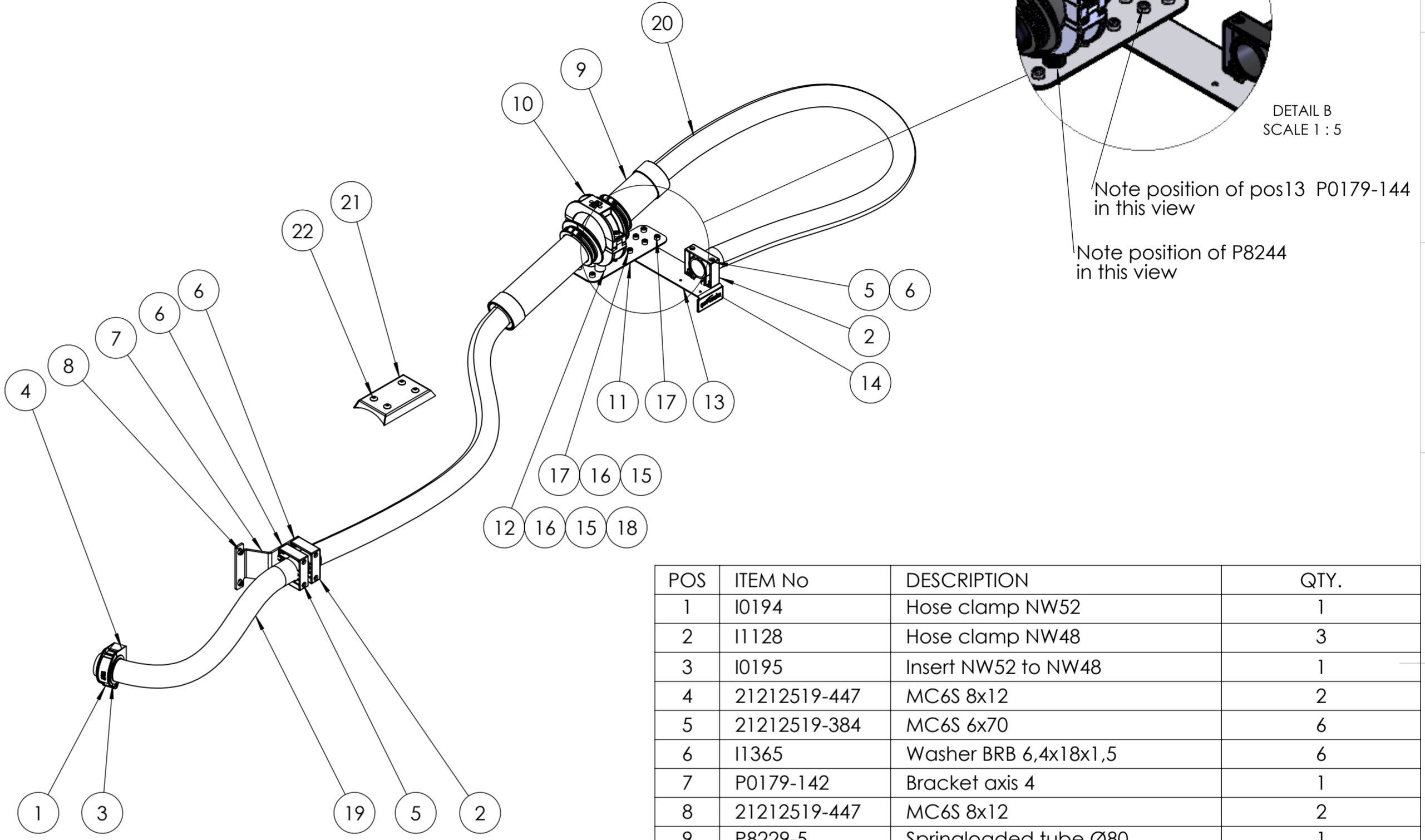

POS	ITEM No	DESCRIPTION	QTY.
1	I0194	Hose clamp NW52	1
2	I1128	Hose clamp NW48	3
3	I0195	Insert NW52 to NW48	1
4	21212519-447	MC6S 8x12	2
5	21212519-384	MC6S 6x70	6
6	I1365	Washer BRB 6,4x18x1,5	6
7	P0179-142	Bracket axis 4	1
8	21212519-447	MC6S 8x12	2
9	P8229-5	Springloaded tube Ø80	1
10	P8244	Swiveling attachment and Clamp	1
11	P0179-143	Axis 3 plate	1
12	P0221-014	Distans	2
13	P0179-144	Bracket	1
14	P0183-094	Small RSP label	1
15	21262801-117	Nut M6M M8 Locking	6
16	9ADA312-7	Washer 8,4x16x1	6
17	21212519-449	MC6S 8x16	8
18	21212519-462	Screw 8x55	2
19	I0340	Protective hose NW48	1
20	I0270	Protective hose NW48	1
21	P0179-145	Protection cover axis 3	1
22	MK6S 10x16	Screw MK6S 10x16	4

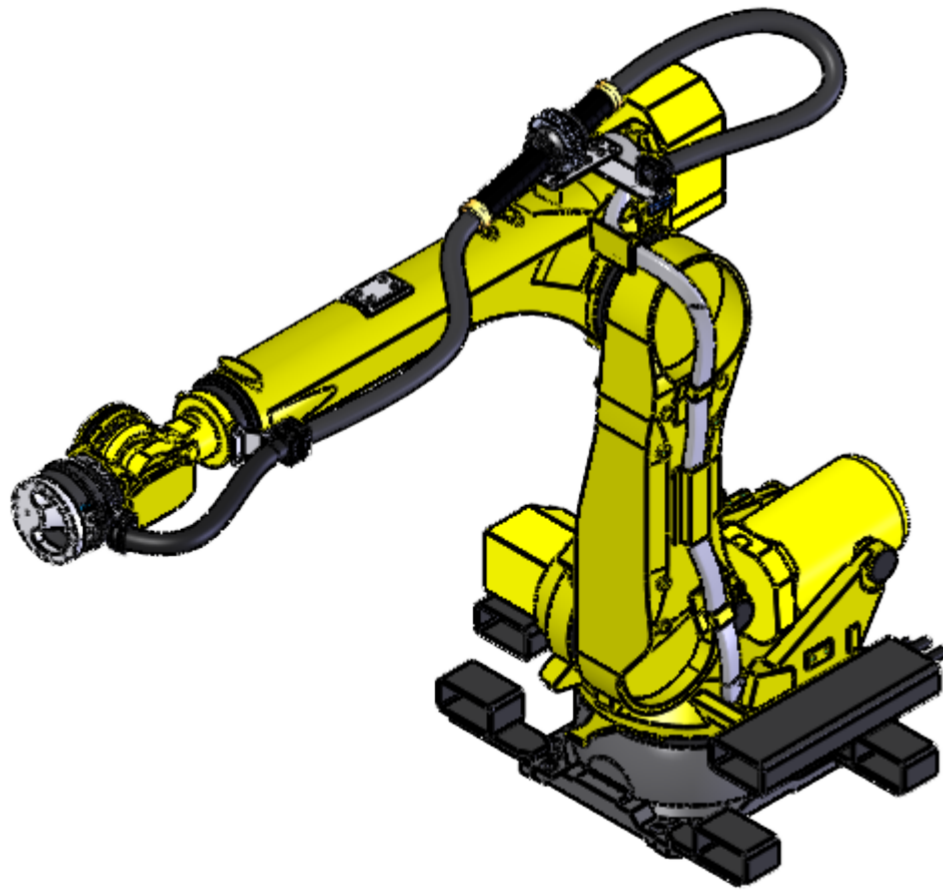

R-2000iC/190U
R-2000iC/210L

Robot	Hose package	See page
R-2000iC/190U	P2457-1	1
R-2000iC/210L	P2457-1	1
R-2000iC/270F	P2457-2	2
R-2000iC/270R	P2457-2	2
R-2000iC/190S	P2457-3	3

Unless otherwise stated the following applies:

Tolerance: _____ Material _____

Surface roughness: Heat treatment / Surface coating _____

Burring class acc. to: _____

Measures valid after heat treatment / coating Circuit diagram _____ Filename _____

Designed by MTh 2023-02-24 Scale 1:10 Description CiRo Hose package, Fanuc R-2000iC

Approved by HENO Weight 7.92 For CiRo XL1

Format A2 Item no. P2457-1 Rev. A Sheet 1(3)

We reserve rights in this document and in the information contained therein. It is strictly forbidden to reproduce, disseminate or use this information without express authority from Robot System Products.

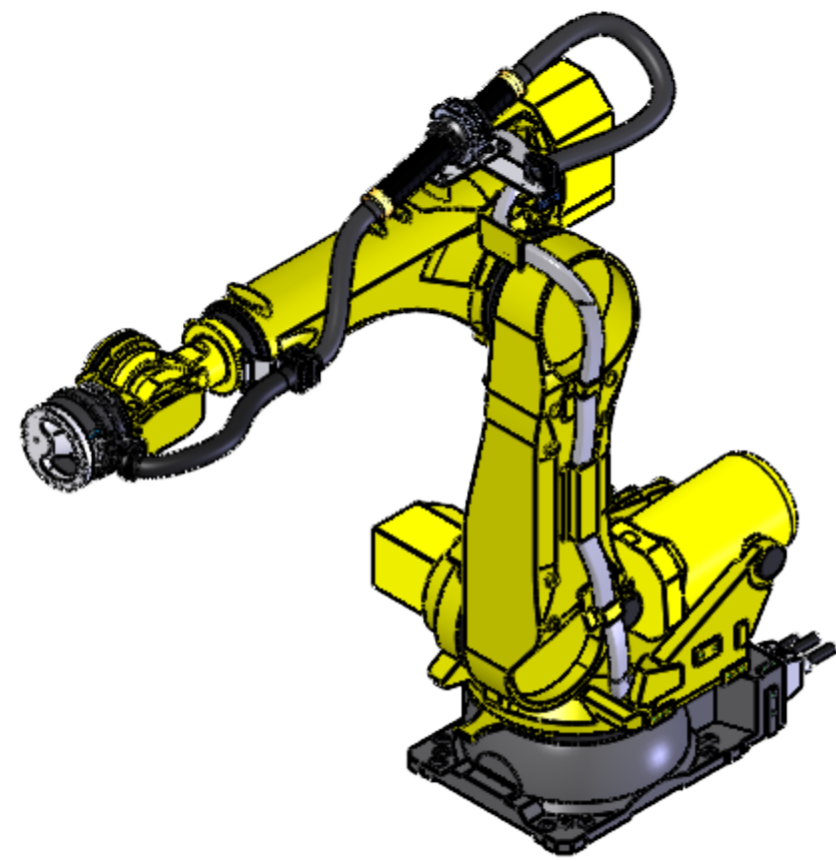

R-2000iC/270F

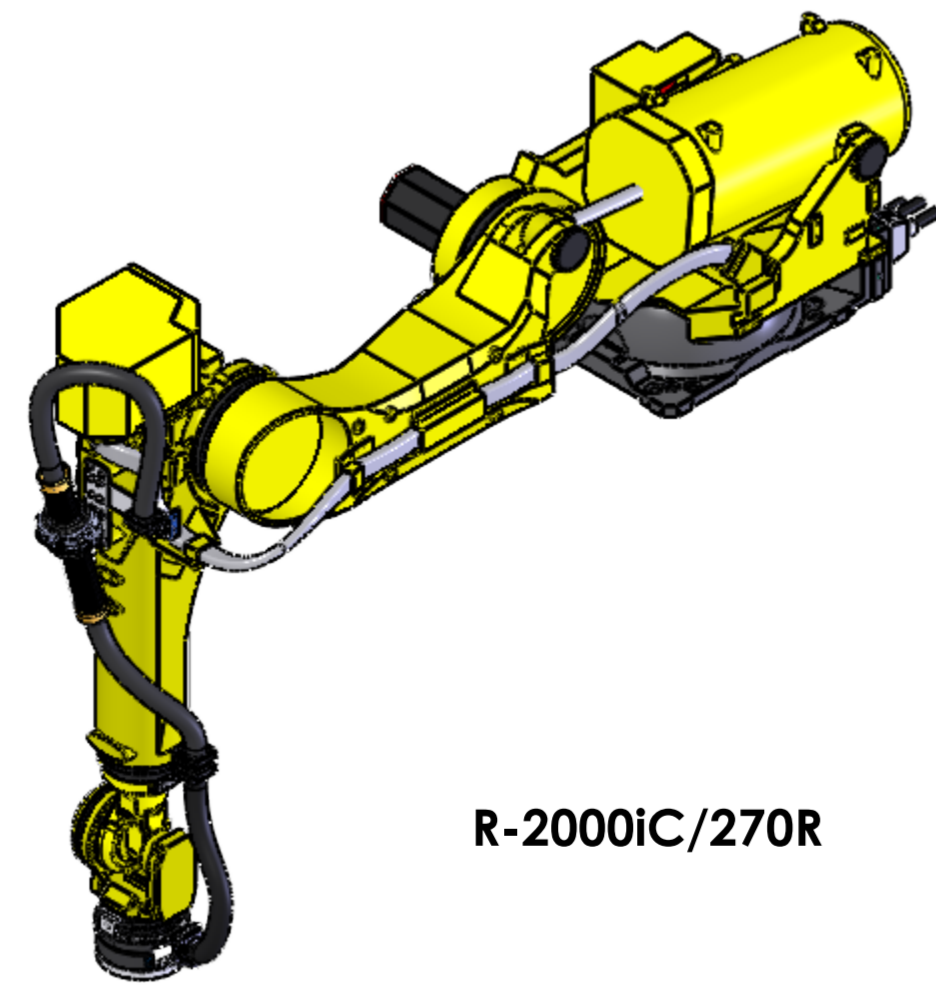

R-2000iC/270R

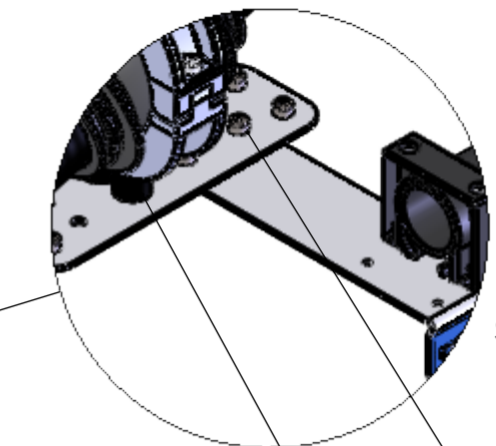
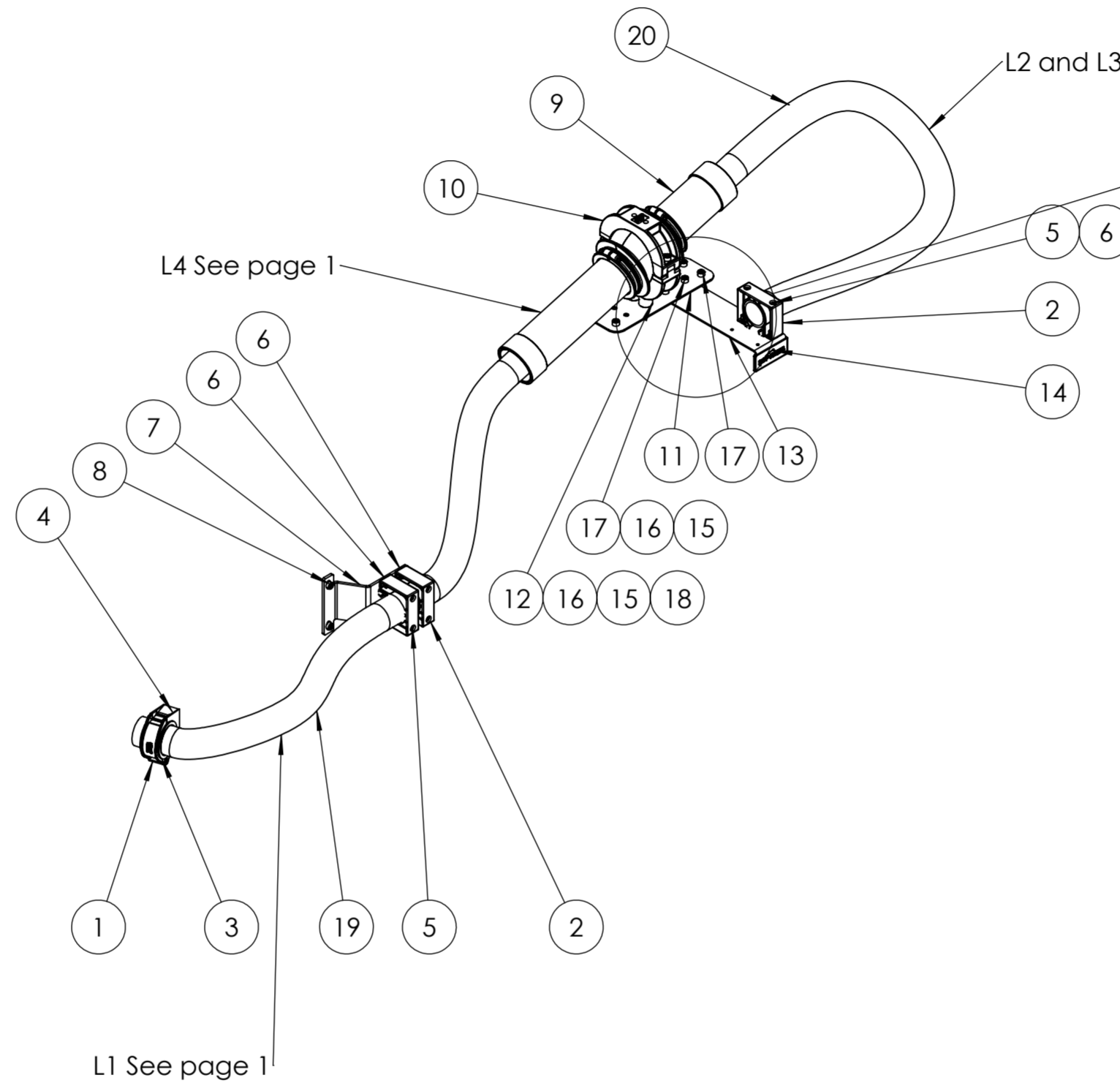

DETAIL C
SCALE 1 : 5

Note position of pos13 P0179-144 in this view

Note position of P8244 in this view

POS	ITEM No	DESCRIPTION	QTY.
1	I0194	Hose clamp NW52	1
2	I1128	Hose clamp NW48	3
3	I0195	Insert NW52 to NW48	1
4	21212519-447	MC6S 8x12	2
5	21212519-384	MC6S 6x70	6
6	I1365	Washer BRB 6,4x18x1,5	6
7	P0179-142	Bracket axis 4	1
8	21212519-447	MC6S 8x12	2
9	P8229-5	Springloaded tube Ø80	1
10	P8244	Swiveling attachment and Clamp	1
11	P0179-143	Axis 3 plate	1
12	P0221-014	Distans	2
13	P0179-144	Bracket	1
14	P0183-094	Small RSP label	1
15	21262801-117	Nut M6M M8 Locking	6
16	9ADA312-7	Washer 8,4x16x1	6
17	21212519-449	MC6S 8x16	8
18	21212519-462	Screw 8x55	2
19	I0340	Protective hose NW48	1
20	I0270	Protective hose NW48	1

Unless otherwise stated the following applies:

Tolerance: Material

Surface roughness: Heat treatment / Surface coating

Burring class acc. to:

Measures valid after heat treatment / coating Circuit diagram Filename: A0179-176

Designed by: MTh 2023-02-24 Scale: 1:10 Description: CiRo Hose package, Fanuc R-2000iC

Approved by: HENO Weight: 7.02 For CiRo XL1

RSP robot system products Format: A2 Item no.: P2457-2 Rev.: A Sheet: 2(3)

We reserve rights in this document and in the information contained therein. Reproduction, distribution and use without express authority is strictly forbidden. Robot System Products

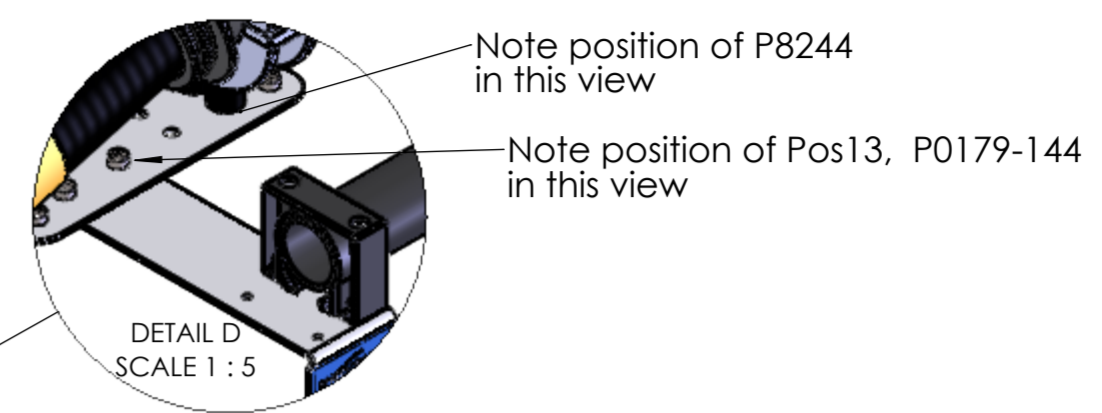
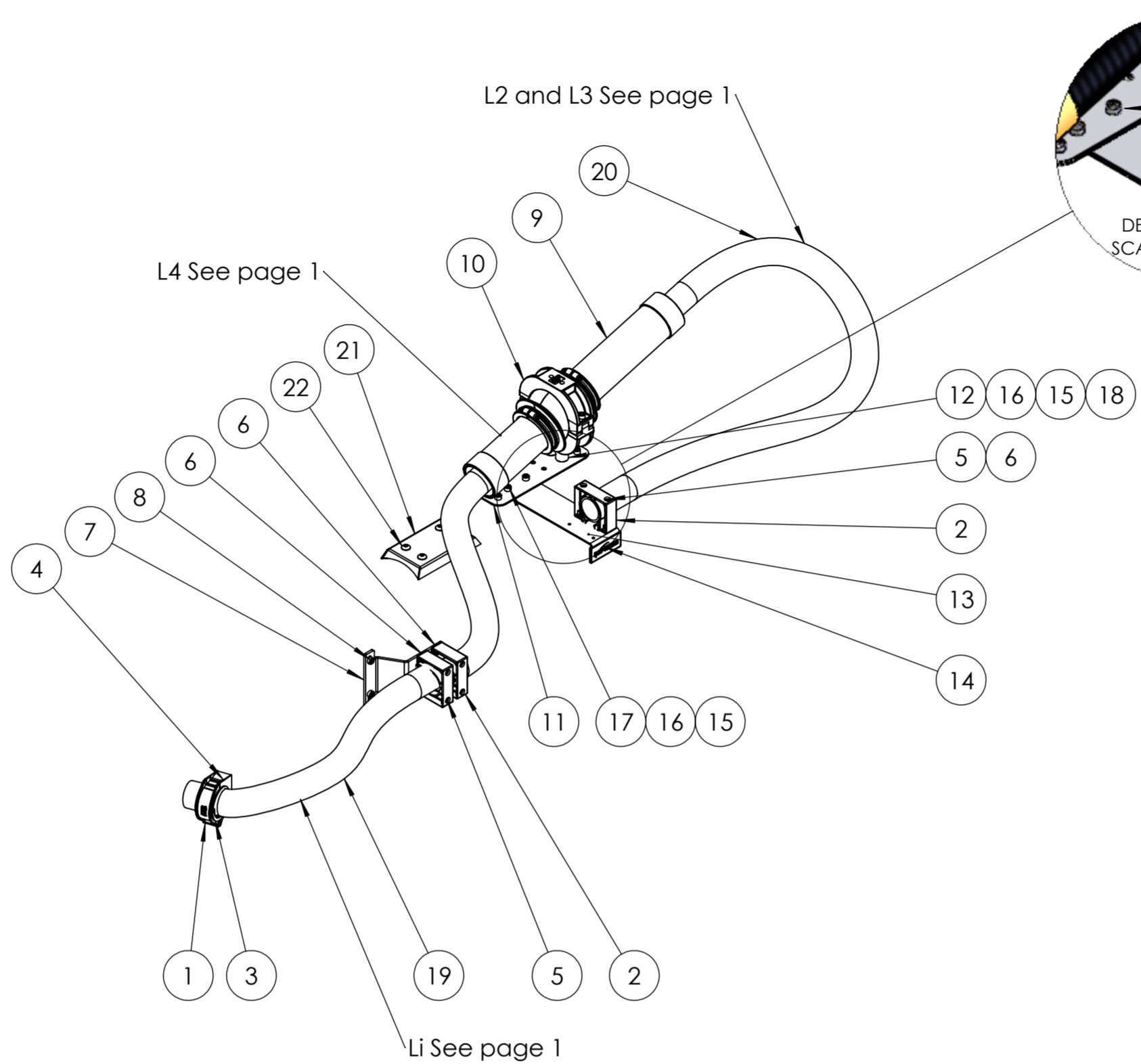

POS	ITEM No	DESCRIPTION	QTY.
1	I0194	Hose clamp NW52	1
2	I1128	Hose clamp NW48	3
3	I0195	Insert NW52 to NW48	1
4	21212519-447	MC6S 8x12	2
5	21212519-384	MC6S 6x70	6
6	I1365	Washer BRB 6,4x18x1,5	6
7	P0179-142	Bracket axis 4	1
8	21212519-447	MC6S 8x12	2
9	P8229-5	Springloaded tube Ø80	1
10	P8244	Swiveling attachment and Clamp	1
11	P0179-143	Axis 3 plate	1
12	P0221-014	Distans	2
13	P0179-144	Bracket	1
14	P0183-094	Small RSP label	1
15	21262801-117	Nut M6M M8 Locking	6
16	9ADA312-7	Washer 8,4x16x1	6
17	21212519-449	MC6S 8x16	8
18	21212519-462	Screw 8x55	2
19	I0340	Protective hose NW48	1
20	i0270	Protective hose NW48	1
21	P0179-145	Protection cover axis 3	1
22	MK6S 10x16	Screw MK6S 10x16	4

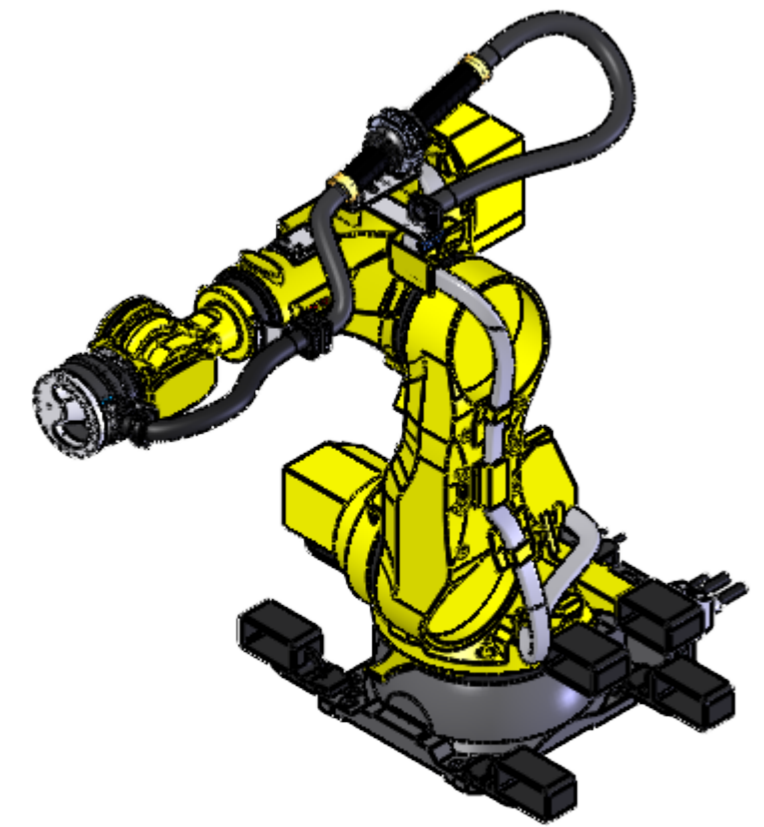

R-2000iC/190S

Unless otherwise stated the following applies:

Tolerance: _____ Material _____

Surface roughness: Heat treatment / Surface coating _____

Burring class acc. to: _____

Measures valid after heat treatment / coating Circuit diagram _____ Filename A0179-176

Designed by MTh 2023-02-27 Scale 1:10 Description CiRo Hose package, Fanuc R-2000iC

Approved by HENO Weight 7.48 For CiRo XL1

Format A2 Item no. P2457-3 Rev. A Sheet 3(3)



We reserve rights in this document and in the information contained therein. All rights are reserved. Reproduction, distribution and use without express authority is strictly forbidden. Robot System Products